



RONDELLE PER BULLONI AD ALTA RESISTENZA PER CARPENTERIA PLAIN WASHERS CHAMFERED FOR HIGH-STRENGTH STRUCTURAL BOLTING

ACCIAIO C45 / STEEL C45

DUREZZA / HARDNESS : 300 - 370 HV

FINITURA / FINISH: OSSIDATE NERE E ZINCATE A CALDO / BLACK OXIDE AND HOT DIP GALVANIZED

COD 45921

DIN 6916
ISO 4759/3 A

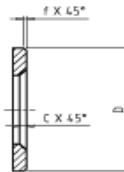
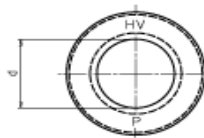

For thread Dimensions in mm	d	D	s	c	f	Mass Kg/1000
M 12	13	24	3	1,6	0,5	7,00
M 14	15	28	3	1,6	0,5	10,5
M 16	17	30	4	1,6	0,75	14,6
M 18	19	34	4	2	0,75	18,9
M 20	21	37	4	2	0,75	19,6
M 22	23	39	4	2	0,75	24,3
M 24	25	44	4	2	0,75	30,6
M 27	28	50	5	2,5	1	50,2
M 30	31	56	5	2,5	1	63
M 33	34	60	5	2,5	1	73
M 36	37	66	6	2,5	1,25	115
M 39	40,4	72	6	3	1,25	132
M 42	43,4	78	8	3	1,5	203
M 45	46,4	85	8	3	1,5	246
M 48	50	92	8	3	1,5	290